

Alu. Openable Door
 D1 - 910 x 2100
 Schedule item no: 39a
 D2 - 750 x 2100
 Schedule item no: 39b
 D3 - 870 x 2100
 Schedule item no: 39c

- Furniture Fittings:-**
- 150x12mm long Alu. towerbolt - 1 no.
 - 125mm long Alu. hinges with screws - 3 nos.
 - 100X150mm Butterfly type handle - 2 nos.
 - Alu. door stopper with double rod - 1 no.
 - Lock - 6 lever (leader brand) - 1 no.
 - Door bush (Nylon) - 1 no.
 - Hydraulic door closer (light duty everite make) - 1no.

Aluminium partition with door @ Console
 Size: 2250x2700mm
 Door Size: D2 - 750x2100mm
 Schedule item No: 38c

Aluminium partition with door @ Clean room
 Size: 1800x2700mm
 Door Size: D1 - 910x2100mm
 Schedule item No: 38a

- Furniture Fittings for single shutter door:-**
- 150x12mm long Alu. towerbolt - 1 no.
 - 125mm long Alu. hinges with screws - 3 nos.
 - 150X200mm Butterfly type handle - 2 nos.
 - Alu. door stopper with single rod - 1 no.
 - Lock - 6 lever (leader brand) - 1 no.
 - Door bush (Nylon) - 1 no.

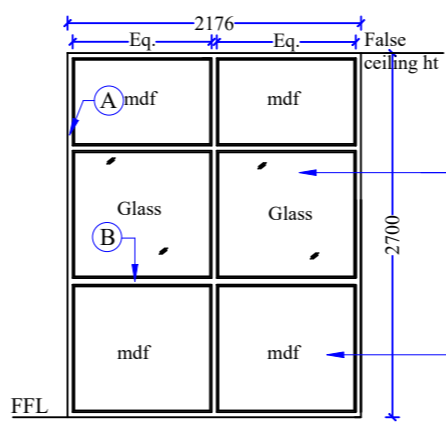

VIEW - 2
 Aluminium partition @ clean room
 Size: 2175x2700mm
 Schedule item No: 38d

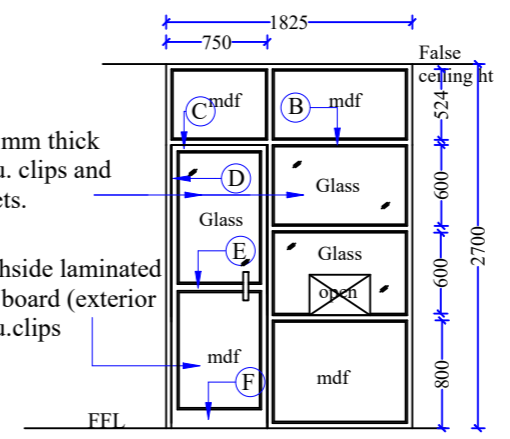

VIEW - 3
 Aluminium partition with door @ Dose admin area
 Size: 1825x2700mm
 Door Size: D2- 750x2100mm
 Schedule item No: 38c

- Furniture Fittings for single shutter door:-**
- 150x12mm long Alu. towerbolt - 1 no.
 - 125mm long Alu. hinges with screws - 3 nos.
 - 150X200mm Butterfly type handle - 2 nos.
 - Alu. door stopper with single rod - 1 no.
 - Lock - 6 lever (leader brand) - 1 no.
 - Door bush (Nylon) - 1 no.

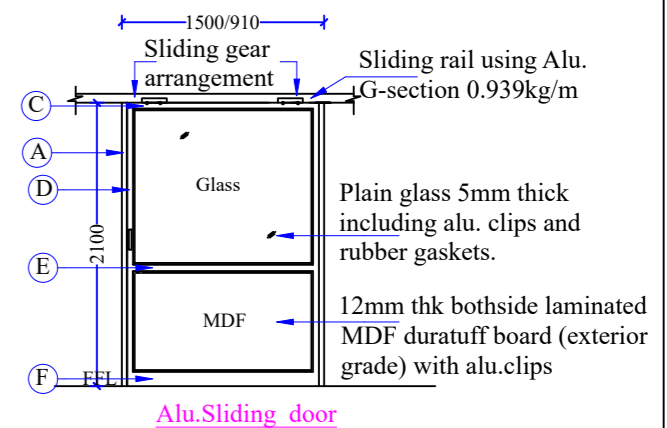

Alu. Sliding door
 Sd - 1500 x 2100mm
 Schedule item no: 40a
 Sd1 - 910 x 2100mm
 Schedule item no: 40b

- Furniture Fittings:-**
- Sliding Door Lock (leader brand) - 1no.
 - D type foldable handle - 1no.
 - 150mm alu.D type handle - 1no.

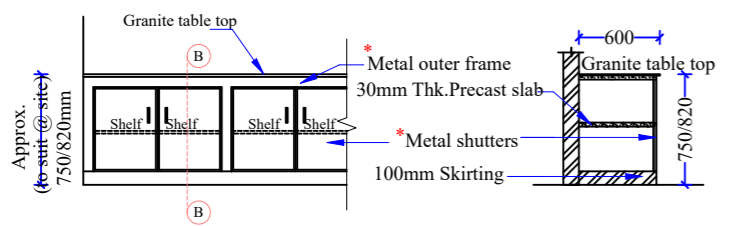

WT / UCB @ waste store room (TYPICAL)
 Schedule item no: 41a

- FURNITURE Fittings For UCB one unit two shutters**
- 75mm long stainless steel hinges with screws - 4Nos.
 - SS Handle 100mm "D" Type - 2Nos.
 - Hafele Lock & Key - 1No.
 - Magnatic Catch - 3Nos.
 - 75mm SS Tower Bolt - 1No.
- FURNITURE Fittings For UCB one unit one shutters**
- 75mm long stainless steel hinges with screws - 2Nos.
 - SS Handle 100mm "D" Type - 1No.
 - Hafele Lock & Key - 1No.
 - Magnatic Catch - 2Nos.

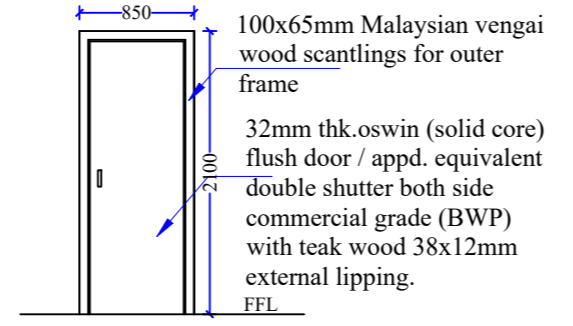

Leadlined Door - LD
 Size: 850 x 2100mm
 Schedule Item no: 37a

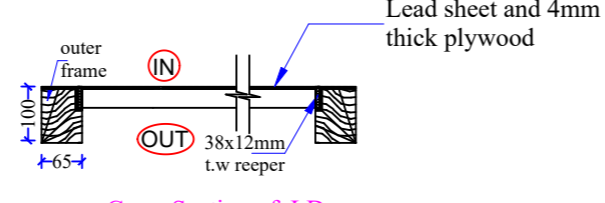

Cross Section of LD

- Furniture Fittings:-**
- M.S. Holdfast 150x50x6mm - 6 nos.
 - 125mm long Alu. ISI hinges with screws - 4 nos.
 - Brass body Mortice lock with handle (link make / approved equivalent make) - 1No.
 - 230x12mm long Alu. towerbolt - 1 no.
 - Door bush Nylon - 1 no.
 - 100mm long Alu. D-type handle - 2 nos.
 - 100mm long Alu. door stopper with double rod (heavy type) - 1 no.
 - Door closer (Paid seperately) - 1no.

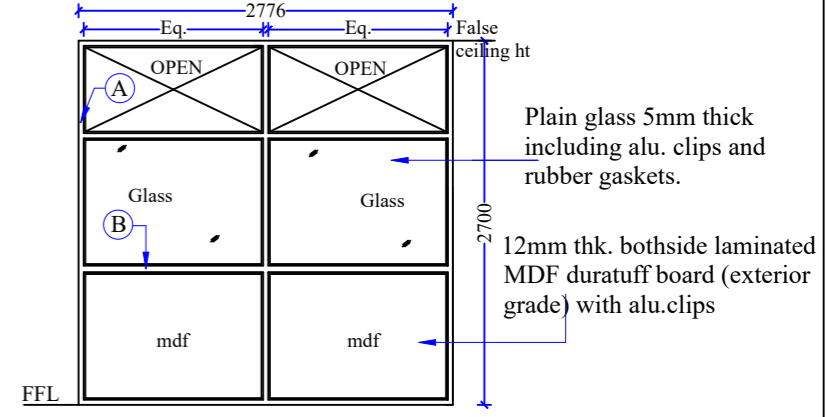

VIEW - 4
 Aluminium partition @ Dose admin area
 Size: 2775x2700mm
 Schedule item No: 38b

DETAILS OF ALU. MEMBERS AS PER JINDAL - CATALOG - 2008

MEMBER	SECTION NO	SECTION SIZE IN MM	THICKNESS SIZE IN MM	SECTION WEIGHT kg/m	
A	PARTITION / DOOR OUTER FRAME	20073	63.50x38.10	1.95	1.092
B	PARTITION - INTERMEDIATE	20072	63.50x38.10	1.85	1.095
C	DOOR SHUTTER - TOP RAIL	19571	47.62x44.50	1.95	0.974
D	DOOR SHUTTER - VERTICAL	19569	47.62x44.50	2.02	1.052
E	DOOR SHUTTER - LOCK RAIL	19575	49.91x44.50	1.60	0.882
F	DOOR SHUTTER - BOTTOM RAIL	19556	101.60x44.50	2.50	1.943
G	BOX SECTION PLAIN	14101	63.50x38.10	1.75	0.974
	CLIP FOR HOLDING MDF - BOARD (OR) GLASS	19370		0.80	0.109

- NOTE:**
- All dimensions are in mm.
 - All alu. fittings are of ISI make. unless otherwise mentioned.
 - All sizes mentioned are approximate to suit site conditions and actual measurements to be taken before execution.
 - All MDF boards material shall be of duratuff exteriorgrade or equivalent make.
 - All aluminium sections are of anodised coated. (approved colour)
 - All Aluminium sections mentioned are of Jindal / approved equivalent make.
 - All panel sizes are as per Engineer's instructions.
 - All glass items mentioned in partition and doors are of MODI/SAINT GOBAIN/ appd. equivalent.
 - All gaps in the aluminium partition joints are to be sealed
 - * are paid separately.

TENDER PURPOSE ONLY

CHRISTIAN MEDICAL COLLEGE - VELLORE

PROPOSED MODIFICATION OF HOT LAB, DOSE ADMIN, SOURCE STORAGE, WASTE STORAGE, DECONTAMINATION, PATIENT WAITING AND CONFERENCE HALL FOR NUCLEAR MEDICINE IN THE FIRST FLOOR OF MAIN BLOCK, CMC TOWN CAMPUS

JOINERY DETAILS

DATE : 22.05.2026	DRG.NO. : CMC/MB/NM/J-001	PLANNING ENGINEER:
DRAWN : YAMUNA	CHECKED : DEVAKI	