

FINISHING SCHEDULE			
ROOM NAME	FLOOR FINISH	WALL FINISH	CEILING
Toilet/Sluice	Vitrified Tile 300x300mm	Wall Tile upto 1500mm & Acrylic Emulsion Painting above upto ceiling	Distemper
Other Areas	Vitrified Tile 600x600mm	Enamel Paint upto 2100mm & Acrylic Emulsion Painting above upto ceiling	Distemper

NOTE:
I. MED:
 OXYGEN AND SUCTION POINT IN TREATMENT ROOM
I. ELECTRICAL:
 PLUG POINT FOR SPOT LIGHT IN TREATMENT ROOM
 PLUG POINT TO BE FIXED FOR PATIENT'S FRIDGE.

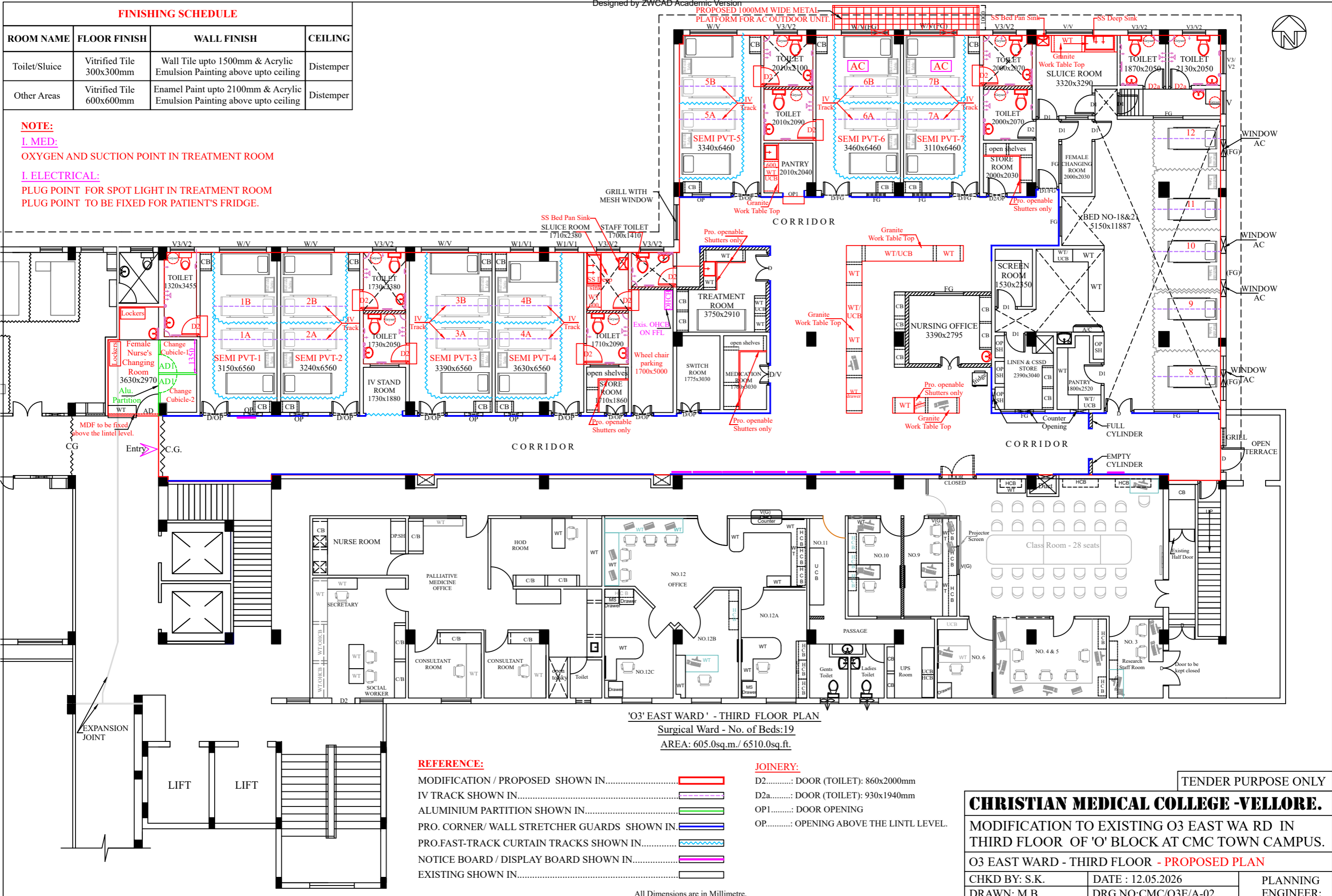

'O3' EAST WARD' - THIRD FLOOR PLAN
 Surgical Ward - No. of Beds:19
 AREA: 605.0sq.m./ 6510.0sq.ft.

- REFERENCE:**
- MODIFICATION / PROPOSED SHOWN IN.....
 - IV TRACK SHOWN IN.....
 - ALUMINIUM PARTITION SHOWN IN.....
 - PRO. CORNER/ WALL STRETCHER GUARDS SHOWN IN.....
 - PRO.FAST-TRACK CURTAIN TRACKS SHOWN IN.....
 - NOTICE BOARD / DISPLAY BOARD SHOWN IN.....
 - EXISTING SHOWN IN.....
- JOINERY:**
- D2.....: DOOR (TOILET): 860x2000mm
 - D2a.....: DOOR (TOILET): 930x1940mm
 - OP1.....: DOOR OPENING
 - OP.....: OPENING ABOVE THE LINTL LEVEL.

TENDER PURPOSE ONLY

CHRISTIAN MEDICAL COLLEGE -VELLORE.

**MODIFICATION TO EXISTING O3 EAST WARD IN
 THIRD FLOOR OF 'O' BLOCK AT CMC TOWN CAMPUS.**

O3 EAST WARD - THIRD FLOOR - PROPOSED PLAN

CHKD BY: S.K.	DATE : 12.05.2026	PLANNING ENGINEER:
DRAWN: M.B.	DRG.NO:CMC/O3E/A-02	

Designed by ZWCAD Academic Version

Designed by ZWCAD Academic Version