

ROOM NAME	FLOOR FINISH	WALL FINISH	CEILING
ICU	Verified Tile 600x600mm		
Isolation Room	Vinyl Flooring		
HDU	Verified Tile 600x600mm	Wall Tile upto false ceiling & Anti-fungal paint above upto ceiling	Metal lay in False ceiling with calcium silicate bulkhead & Anti-Fungal Paint on Ceiling
Sluice Room/Toilets	Verified Tile 600x600mm		
Equipment Store/ABG Room	Verified Tile 600x600mm		
Day/ Doctor Room/Sisters Office/Consultant Office	Verified Tile 600x600mm	Acrylic Emulsion painting upto ceiling.	
Pantry/Female & Male Change/Store Room	Verified Tile 600x600mm	Acrylic Emulsion painting upto ceiling.	
Classroom/Counselling Room	Verified Tile 600x600mm	Acrylic Emulsion painting upto ceiling.	
Store Room	Verified Tile 600x600mm	Acrylic Emulsion painting upto ceiling.	Anti-Fungal Paint

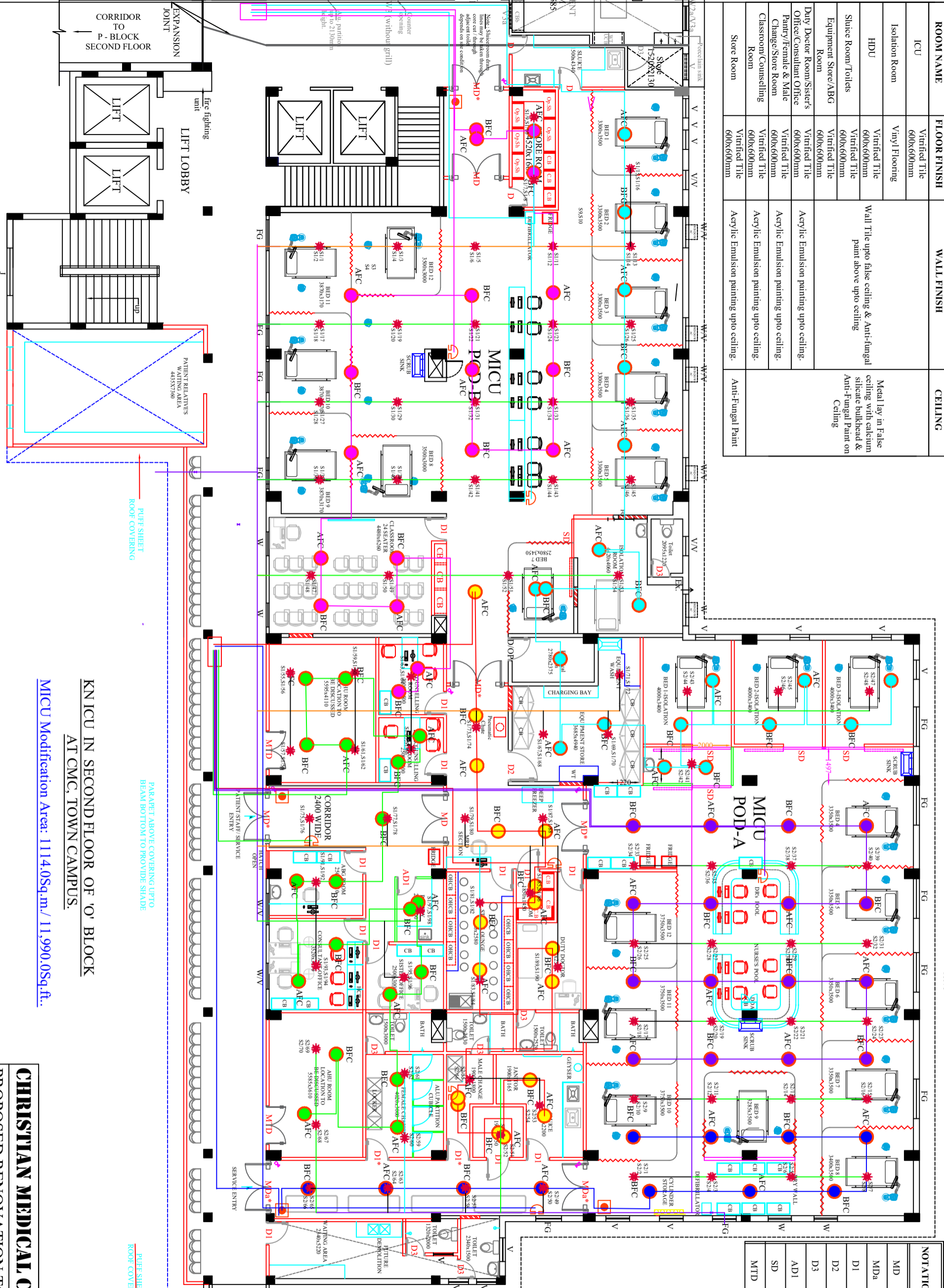

KNICU IN SECOND FLOOR OF 'O' BLOCK
AT CMC, TOWN CAMPUS.

MICU Modification Area: 1114.0Sq.m / 11,990.0Sq.ft.

REFERENCE:
■ PROPOSED SHOWN IN
■ EXISTING SHOWN IN

NOTATION	DESCRIPTION	SIZE OF OPENING	SILL	LINTEL
MD	Door	2100 X 2100	-	2100
Mda	Door	2050 X 2100	-	2100
D1	Door	900 X 2100	-	2100
D2	Door	1200 X 2100	-	2100
D3	Door	750 X 2100	-	2100
AD1	Aluminum Door	750 X 2100	-	2100
SD	Sliding Door	1500 X 2100	-	2100
MTD	Metal Door	1500 X 2100	-	2100

LEGEND

- Smoke Detector
- Hoover
- Manual Call Point
- Fire Alarm Panel
- Sprinkler

LEGEND

- 100mm MS Pipe
- 80mm MS pipe
- 65mm MS Pipe
- 50mm MS Pipe
- 40mm MS Pipe
- 25mm MS Pipe

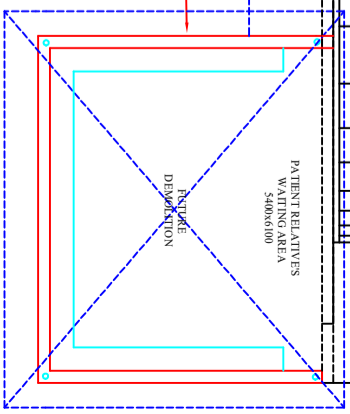

CHRISTIAN MEDICAL COLLEGE -VELLORE.

PROPOSED RENOVATION TO KNICU, FOR MICU IN
SECOND FLOOR OF 'O' BLOCK AT CMC TOWN CAMPUS.

SECOND FLOOR PLAN - PROPOSED PLAN

CHKD BY: _____ DATE : 18.12.2025 PLANNING ENGINEER:
 DRAWN: DAVID ANDREW DRG.NO:CMC/OB/KNICU-A01